

PARTS LIST

ITEM	QTY	PART NUMBER	MATERIAL	DESCRIPTION	TORQUE SET	MASS
1	1	BOV_100_90_PC_MAIN FLANGE	316L	PL12 X 218 X 218		2,282 kg
2	1	BOV_100_90_PC_MAIN FLANGE PIPE	316L	4" SCH40 PIPE X 67		0,356 kg
3	1	BOV_100_90_STD_PC_ELBOW_003	316L	4" SCH 10		1,346 kg
4	1	BOV_100_90_PC_OUTLET FLANGE	316L	PL 10 X 173 X 173		0,984 kg
5	1	BOV_100_90_PC_OJ_SJ_WELD IN GLAND BOX	316L	RB 80 X 73		1,312 kg
6	4	BOV_100_90_PC_CAGE LEGS	316L	RB 16 X 66	50 Nm	0,067 kg
7	1	BOV_100_90_PC_ACTUATOR HOUSING	316L	RB 80 X 81		0,778 kg
8	2	ENC O-RING BS114	ENC	BS114 (2.62 X 15.54)		0,000 kg
9	1	BOV_100_90_PC_M36 PLUG	316L	RB 40 X 18	25 Nm	0,057 kg
10	1	BOV_100_90_PC_M36 PLUG TEFLON BUSH	TEFLON	RB 30 X 13		0,002 kg
11	2	ENC O-RING 3.53 X 55.55	ENC	3.53 X 55.55		0,002 kg
12	1	BOV_100_90_PC_ACTUATOR PISTON	316L	RB 60 X 31		0,234 kg
13	1	BOV_100_90_PC_OJ_SJ_ACTUATOR PISTON ROD	316L	RB 16 X 137		0,182 kg
14	1	O-RING VITON 3.53 X 55.55	VITON	3.53 X 55.55		0,002 kg
15	1	BOV_100_90_PC_M65.5 PLUG	316L	RB 70 X 20		0,297 kg
16	1	O-RING VITON 3 X 60	VITON	O-RING VITON 3 X 60		0,001 kg
18	1	ENC O-RING BS344	ENC	BS344 (5.33 X 97.72)		0,009 kg
19	1	ENC O-RING BS343	ENC	BS343 (5.33 X 94.62)		0,009 kg
20	1	BOV_100_90_PC_MAIN PISTON RING	316L	PL 8 X 102 X 102		0,151 kg
21	1	SPRING AMF-004	SS	ID:48.2 FL:160 TC:8.75		0,363 kg
22	1	BOV_100_90_PC_CAGE	316L	RB 150 X 54		1,061 kg
23	1	6MM AIR FITTING Elbow Swivel 90° 1/8 BSP	SS	Male Elbow		0,001 kg
24	1	BOV_100_90_PC_STRAINER	SS MESCH	STRAINER		0,151 kg
25	1	BOV_100_90_PC_STRAINER PLATE	316L	PL 3 X 158 X 158		0,296 kg
26	4	M5	SS	Spring Washer		0,000 kg
27	4	M5 x 16 ALLEN CAP SCREW	SS	Socket head cap screws	6Nm	0,004 kg
28	2	M4 x 4 Cup Point	SS	Socket set screws	4Nm	0,000 kg
57	1	BOV_100_90_PC_OJ_SJ_MAIN PISTON	316L	MAIN PISTON		1,121 kg
60	1	BOV_100_90_PC_OJ_SJ_JACKET ELBOW RING	316L	PL 6 X 126 X 70		0,126 kg
61	1	BOV_100_90_PC_OJ_SJ_BOTTOM FLANGE JACKET RING	316L	PL 6 X 127 X 77		0,111 kg
68	1	BOV_100_90_PC_OJ_SJ_JACKET RADIUS STRIP A	316L	PL 6 X 100 X 68		0,038 kg
71	1	BOV_100_90_PC_OJ_SJ_SUMP PLUG	316L	RB 20 X 21		0,034 kg
72	1	BOV_100_90_PC_OJ_SJ_SUMP PLUG WASHER	Brass	RB 20 X 3		0,003 kg
74	1	BOV_100_90_PC_OJ_SJ_JACKET RADIUS STRIP B	316L	PL 6 X 100 X 68		0,038 kg
86	2	BOV_100_90_PC_SJ_ADR_NIPPLE 3.4	316L	RB 30 X 33		0,045 kg
87	1	BOV_100_90_PC_SJ_ADR_STEAM JACKET PLATE	316L	PL 2 X 395 137		0,698 kg
88	1	BOV_100_90_PC_SJ_ADR_GLAND BOX STEAM PLATE	316L	PL 6 X 168 X 131		0,633 kg

NOTE:  
ALL THREADED PARTS TO BE GREASED  
WITH COPPER COMPOUND

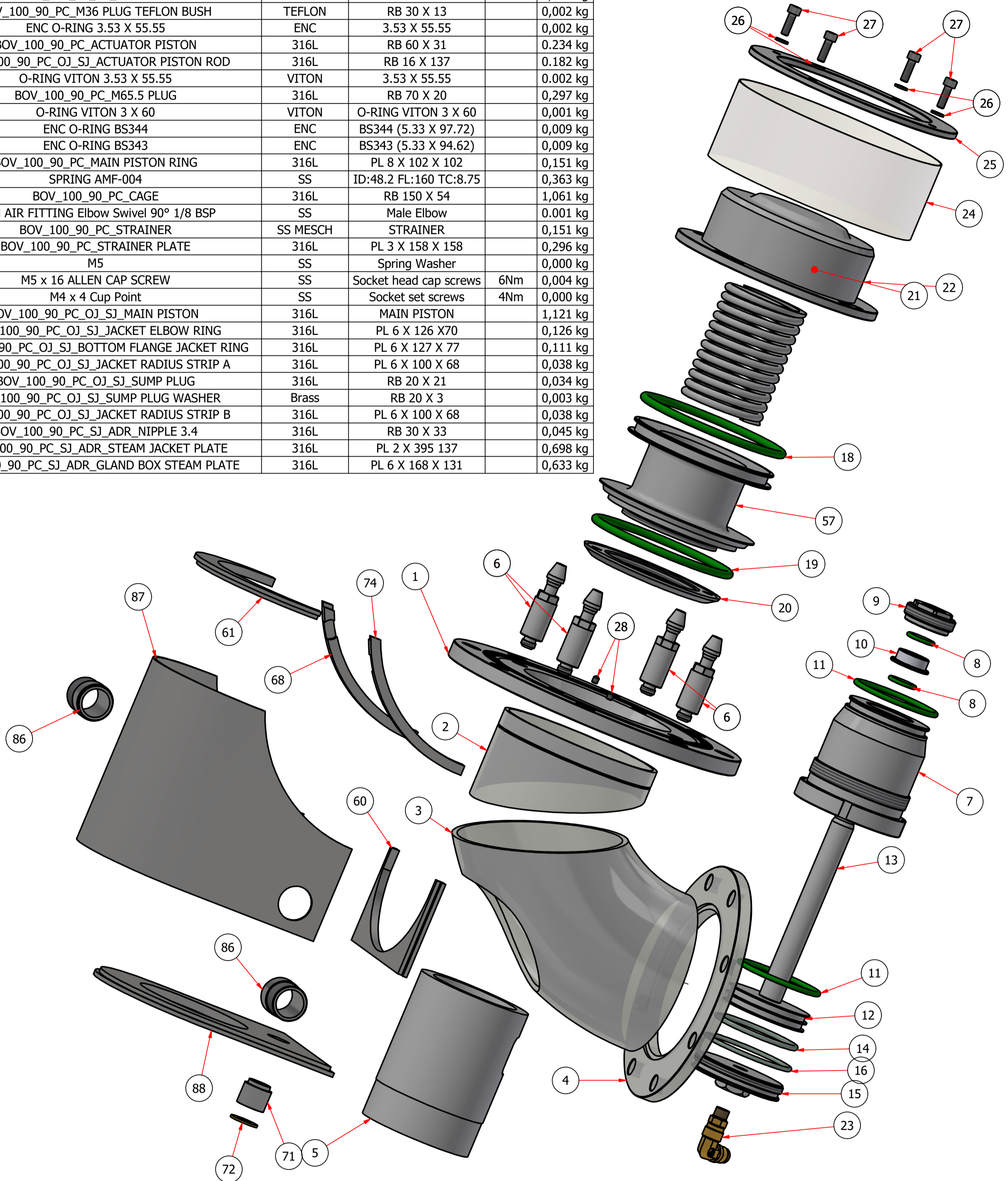

NO TRANSFER OF INTELLECTUAL PROPERTY : Any & all drawings, documentation, information or data provided by AMF to be used solely for the use intended by AMF, nor may it be shared, copied, distributed or disseminated in any manner whatsoever. All intellectual property, including AMF's drawings, shall remain the sole property of AMF.



APPROVED R.P.M.J.	2022/11/02
TITLE 100mm PC STEAM JACKET PARTS ASSEMBLY	
SIZE A2	DWG NO AMF_BOV_100_90_PC_SJ_ADR_316L
SCALE 1 : 2	REV 3
SHEET 1 OF 1	